

New from FlashCo®

In Conjunction
with  THALER
Metal USA Inc.

Retrofit Drains

The first affordable retrofit drain solution.



Single Bolt Action
Installs in Minutes

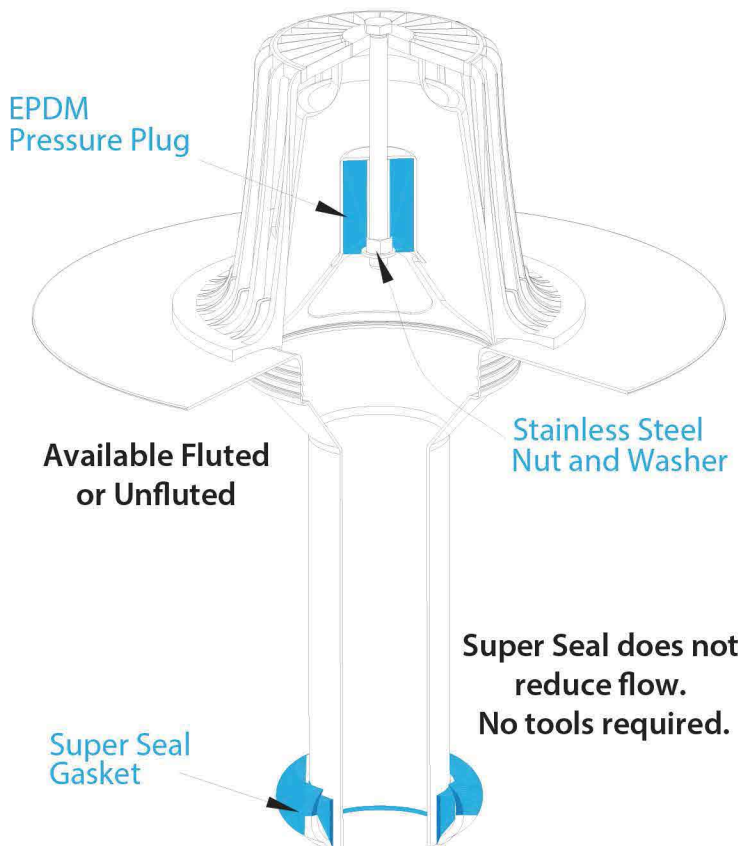

Finally, an affordable drain solution for your retrofit and new construction needs

- Easy to install. Get off the roof sooner and save installation costs.
- Maximum flow, maintenance free and comes with a 20 year warranty on Super Seal technology.
- One bolt secures strainer and compresses membrane.
- Retrofit available in 2", 3", 4", 5", 6" fluted or unfluted/90 degrees.
- Super Seal Gasket included.
- TPO, or PVC drain pan sold separately.

Call Now for a Custom Quote!

FlashCo®
ROOF FLASHINGS & ACCESSORIES
Saving the Contractor Time! 

Sales@FlashCoMfg.com

www.FlashCoMfg.com

1-866-323-5274

WHAT IT TAKES TO BE THALER OR EQUAL

When specifications read Thaler or Equal, it is responsibility of specifiers and building owners to determine what it means to be “Or Equal”. The following data has been presented to quickly help assess the comparative merits of “competitive” products. Thaler roof Drain products have several Value Added features that should be considered when trying to equate the “Or Equal”.

CHECK THE COMPETITION	THALER VALUE ADDED FEATURES
<input type="checkbox"/>	<input checked="" type="checkbox"/> Fast installation; all Thaler new and retrofit roof drains are quickly installed in a few minutes or less vs. nearly an hour for some competitive products.
<input type="checkbox"/>	<input checked="" type="checkbox"/> Fits more leader diameters (as applicable); accommodates all leader sizes 2” to 10” (51 mm to 254 mm) diameter.
<input type="checkbox"/>	<input checked="" type="checkbox"/> ANSI Approved; All Thaler roof drains awarded: CSA B79 (2008) - ASME A112.6.4 (2012).
<input type="checkbox"/>	<input checked="" type="checkbox"/> Modern accessories; compare Thaler accessories with our competition with regard to best and most up-to-date offering (see Thaler Roof Drain Options literature). Check out fast, new-to-the-industry EPDM retrofit seal, PVC or bituminous coated flashing deck flanges, and T-7 Flow Control accessory.
<input type="checkbox"/>	<input checked="" type="checkbox"/> New RDX30 series drain; brand new all-purpose, patented retro-fit design provides unique 360° membrane clamping ring (compression unit), super fast installation, superior outlet-to-leader seal and the toughest vandal-proof strainer on the market today.
<input type="checkbox"/>	<input checked="" type="checkbox"/> 100% corrosion free; all drains are manufactured using non-corrosive metals or other materials (non-galvanized or other non-durable materials).
<input type="checkbox"/>	<input checked="" type="checkbox"/> Treated deck flange; can be PVC coated for proper weld of PVC membrane or bituminous painted for proper adhesion of BUR or ModBit membrane.
<input type="checkbox"/>	<input checked="" type="checkbox"/> Super-Seal EPDM Retrofit Drain Seal; patented EPDM sealing ring provides a superior outlet-to-leader seal in the event drains or pipes become clogged (see Thaler Super-Seal Retrofit Drain Seal literature).
<input type="checkbox"/>	<input checked="" type="checkbox"/> Vandalproof strainer (as applicable); non-removable dome strainer eliminates improper strainer installation or lost strainers that can result in plugged drains, while vandalproof hinged gate (allen-key openable) allows drains to be cleaned if necessary.
<input type="checkbox"/>	<input checked="" type="checkbox"/> 20 year Warranty; guaranteed against leaks, condensation and defects in materials and/or manufacture when installed in accordance with Thaler “Installation Instructions”.
<input type="checkbox"/>	<input checked="" type="checkbox"/> Maintenance-Free; apart from industry recommended semi-annual preventative inspection to keep drains clear of debris, Thaler drains do not require any maintenance.
<input type="checkbox"/>	<input checked="" type="checkbox"/> Written “Installation Instructions”; provided with every Thaler product.
<input type="checkbox"/>	<input checked="" type="checkbox"/> Intertek certified

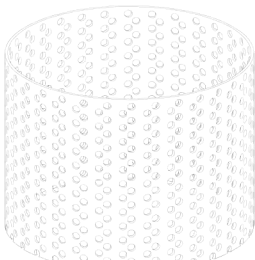

T-12 STAINLESS STEEL BALLAST GUARD

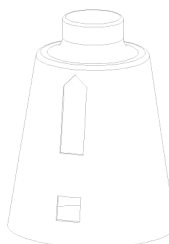

T-7 ALUMINUM FLOW CONTROL ACCESSORY

Note: Specify accessories required by ad appropriate suffix to model number e.g. RD A-T-6 for ferrule, T-7 for flow control, T-10 stainless steel underdeck clamp and T-12 stainless steel ballast guard.

ROOF SPECIALTIES RDX30-A-RR ECONOMY ALUMINUM SUPER-SEAL RETROFIT ROOF DRAIN (All Purpose, Funnel Outlet)

DESCRIPTION:

The Thaler RDX30-A-RR Super-Seal Roof Drain consists of a vandalproof cast aluminum strainer, aluminum strainer retainer/membrane compression unit, deck flange with funnel type straight aluminum outlet fitted with a patented EPDM sealing ring (Thaler Super-Seal). The Super-Seal provides a superior seal in the event drains or pipes become clogged (see Thaler Super-Seal Retrofit Drain Seal literature).

PROMINENT FEATURES:

Faster, more economical and easier installation (2 minutes) than competitively positioned drains (no special expertise required). Provides extremely reliable outlet/leader seal. Unique strainer retainer/membrane compression unit also provides best obtainable seal around deck flange by clamping membrane perfectly at a critical juncture (no lateral leakage into roof membrane). Strainer is rendered vandalproof via 3/8" (10 mm) dia. s.s. retaining bolt.

LEADER DIAMETERS:

Suitable for 1-3/4", 2", 2-3/4", 3", 3-3/4", 4", 4-3/4", 5-3/4" and 6" (44 mm, 51 mm, 70 mm, 76 mm, 95 mm, 102 mm, 121 mm, 146 mm and 152mm) (152 leader sizes).

OPTIONS:

Copper or stainless steel model also available. T-7 aluminum Flow Control accessory (weir) for utilizing roof as temporary reservoir during excessive rainfall. T-10 stainless steel underdeck clamp. T-12 stainless steel ballast guard for inverted roof applications. PVC coated deck flange for PVC roof membrane. Bituminous painted deck flange for BUR and ModBit roof membrane.

RECOMMENDED USE:

Primarily all purpose retrofit economy drain for flat roofs employing conventional roof membrane applications (without ballast guard) or inverted roof membrane applications (with ballast guard). Suitable for PVC, cast iron, steel, copper, or other type leaders.

APPROVALS:

Awarded CSA B79 (2008) - ASME A112.6.4 (2012).

WARRANTY:

20 year warranty against defects in materials and/or manufacture when installed in accordance with Thaler "Installation Instructions". Copy of Warranty Certificate available upon request.

MAINTENANCE

No maintenance required (maintenance free), however, as per CRCA/NRCA recommendations, drains should be inspected twice a year (spring and fall) and any debris removed from both around and inside the strainer.

SPECIFICATION (SHORT FORM):

Roof drains: Thaler RDX30-A-RR drain for [1-3/4" (44 mm)] to [6" (152 mm)] leader size, with: vandalproof cast aluminum strainer with integral gravel guard fins and 3/8" (10 mm) s.s. retaining bolt; strainer retainer/membrane compression unit; .064" (2 mm) spun aluminum compression unit; deck flange with funnel type straight outlet fitted with Super-Seal EPDM sealing ring; [T-7 aluminum flow control accessory;] [T-10 stainless steel underdeck clamp;] [T-12 perforated 22 ga. (0.76 mm) s.s. ballast guard;] [PVC coated deck flange] [bituminous painted deck flange]; manufactured by Thaler Metal Industries, 1-800-387-7217 (Mississauga, Ontario, Canada) or 1-800-576-1200 (USA), installed as per manufacturer's written instructions. Provide standard 20 year warranty against defects in materials and/or manufacture.

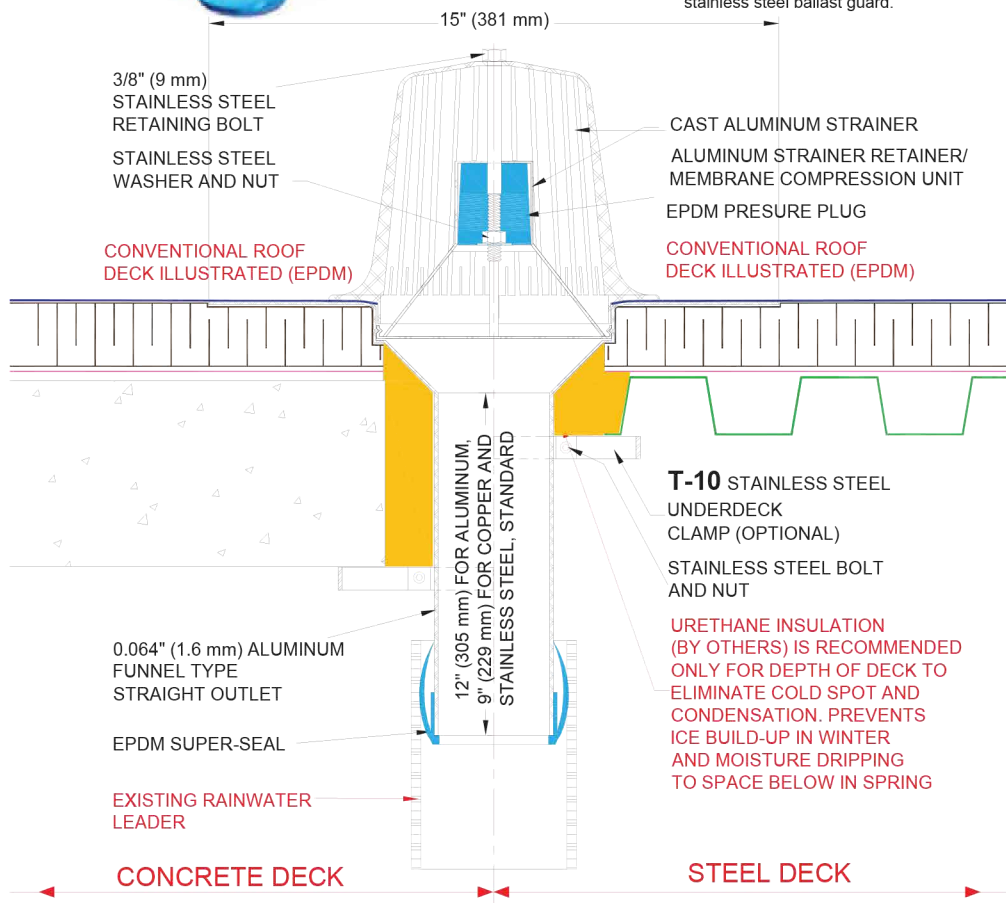

RDX30-A-RR RETROFIT ROOF DRAIN (Aluminum, Funnel Type Outlet)
RDX30-C-RR RETROFIT ROOF DRAIN (Copper, Funnel Type Outlet)
RDX30-SS-RR RETROFIT ROOF DRAIN (Stainless Steel, Funnel Type Outlet)
 Note: RDX30-C-RR (Copper) and RDX30-SS-RR (Stainless Steel) similar.
 See reverse side of page for material changes.

INSTALLATION:

"Installation Instructions" are provided with every Thaler product. Essentially, the Thaler RDX30-A-RR roof drain is installed by fitting and connecting the drain outlet into the rainwater leader, slowly pushing down into position, screwing the strainer retainer/membrane compression unit into the funnel, carefully bolting down the strainer to clamp the membrane to the deck flange, and as follows:

- BUR:** Set drain flange over membrane in layer of plastic cement and flash in with 3 overlapping layers of felt flashing.
- ModBit:** Torch membrane until bitumen is fluid and set drain flange into fluid. Flash in flange with two overlapping layers of ModBit and seal with asphalt sealer.
- Single Ply:** Set drain flange in layer of membrane adhesive before applying membrane over flange. Note: for PVC membrane, specify PVC coated drain flange by adding suffix P to end of model number, e.g. RDX30-A-RR-P; weld roofing to drain flange using PVC torch.
- Precautions:** If coating drain flange with a bituminous paint on site, allow 24 hours for drying before applying roof membrane.
- Ordering and Availability:** Available throughout North America. Contact Thaler for list of distributors and current cost information. Most products are readily available from stock.





RDX30-SS-RR
Stainless Steel Roof Drain
 Showing Aluminum strainer
 Retainer/ Compression Unit
 Screwed to Drain Body



RDX30-C-RR Copper
Roof Drain

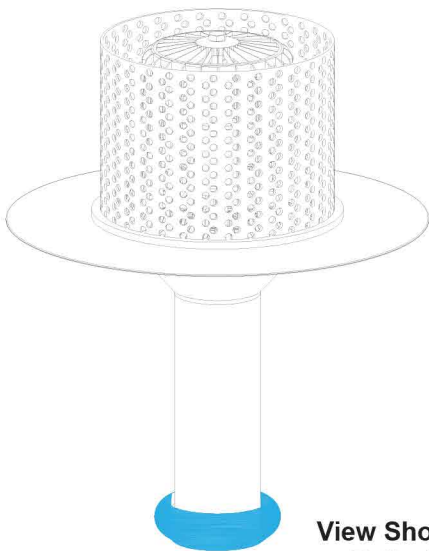

View Showing T-12
Ballast Guard
Friction Fitted to
Dome Strainer

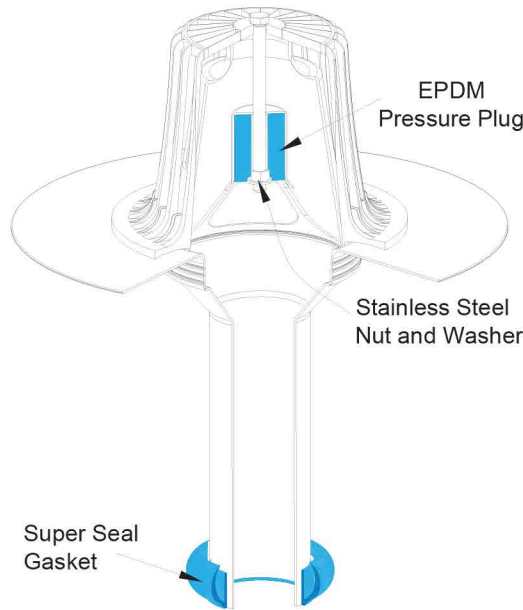

Cut-Away View Showing
Aluminum
Strainer Retainer/Membrane
Compression Unit

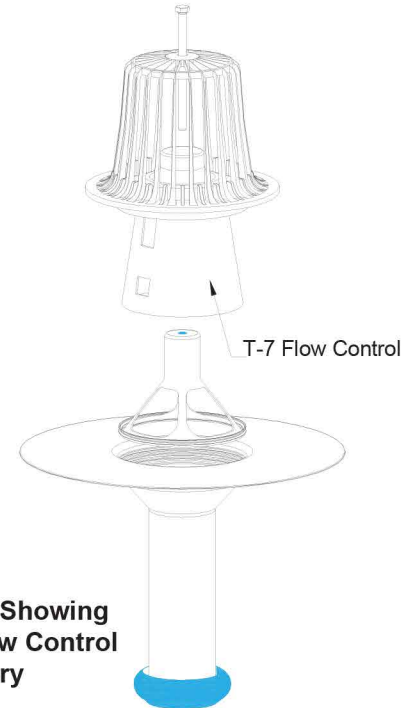

Exploded View Showing
Optional T-7 Flow Control
Accessory

Material Specification for RDX30-C-RR (Copper) and RDX30-SS-RR (Stainless Steel) Roof Drains (RDX30-A-RR Aluminum Illustrated on page M-24)

Note: In Short Form specification on front side of sheet, edit clause to reflect choice of copper (RDX30-C-RR) or stainless steel (RDX30-SS-RR) roof drain in lieu of aluminum if desired.

Drain Type	Strainer	Underdeck Clamp	Drain Body and Base	Membrane Compression Unit	T-6 Ferrule	T-7 Flow Control	T-12 Ballast Guard
RDX30-A-RR	Cast Aluminum	Stainless Steel	Aluminum 0.064" (1.6 mm)	Aluminum	Aluminum	Aluminum	Stainless Steel
RDX30-C-RR	Cast Aluminum	Stainless Steel	Copper base: 24 oz. 0.032" (0.831 mm) pipe: DWV 0.058" (1.47mm)	Copper	Brass	Copper or Painted Aluminum	Stainless Steel
RDX30-SS-RR	Cast Aluminum	Stainless Steel	Stainless Steel base: 22 Ga. (0.8mm) pipe: Type 304 L 0.12" (3mm)	Stainless Steel	Stainless Steel	Painted Aluminum or Stainless Steel	Stainless Steel

1

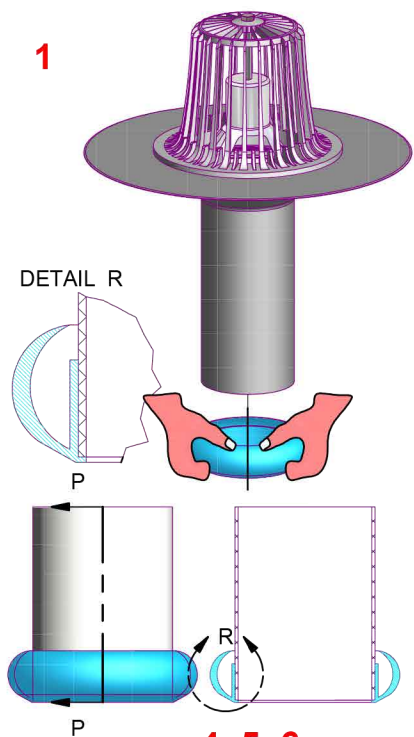

4, 5, 6

Lubricate outside surface of Super Seal with silicone

7

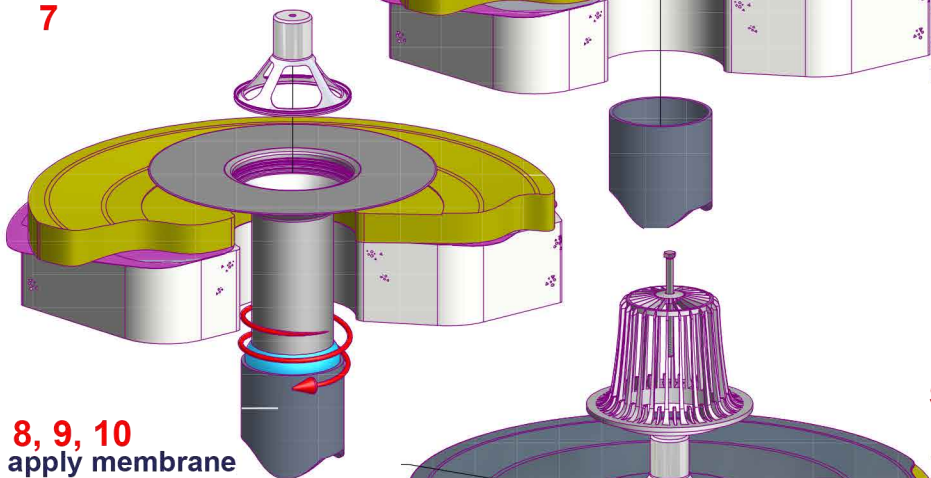

8, 9, 10 apply membrane flashing neatly around drain opening using inside lip of flange as a guide.

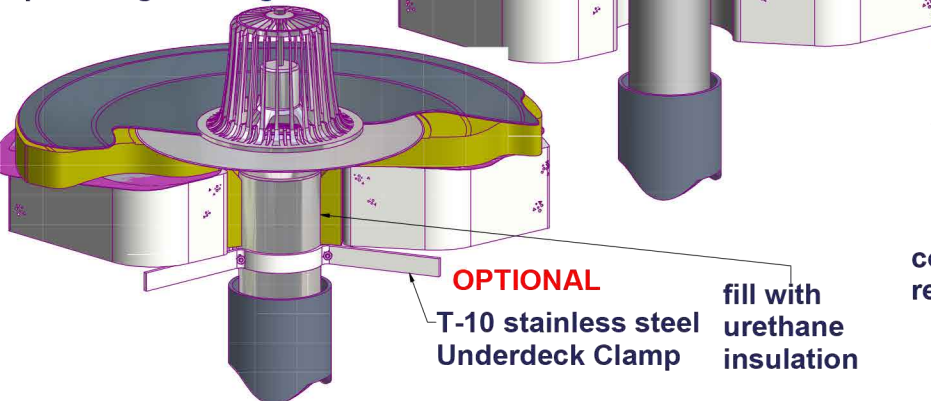

OPTIONAL T-10 stainless steel Underdeck Clamp fill with urethane insulation

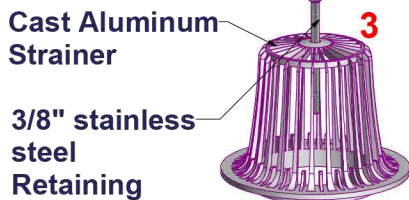

3

Cast Aluminum Strainer
3/8" stainless steel Retaining Bolt
Compression Unit

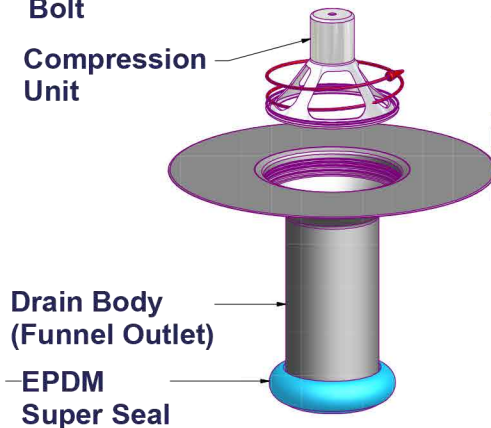

Drain Body (Funnel Outlet)
EPDM Super Seal

STEP 1

Stretch the EPDM Super Seal over the Drain Outlet outside diameter so that outlet sits on small lip.

STEP 2

Clean existing drain pipe. Prepare existing roofing so that insulation is tapered for slope to drain minimum 1/2" on 3' radius.

STEP 3

Disassemble delivered drain. Remove 3/8" stainless steel retaining bolt using 9/16" wrench and Cast Aluminum Strainer.

For modify or single ply applications remove compression unit from drain body.

For BUR roof applications do not remove compression unit.

The day before installation apply coat of primer over the top and bottom of drain body flange as per manufacturer's instructions.

STEP 4

Trim the roof membrane around the existing roof drain opening 2" wider.

STEP 5

Clean the surfaces free from dirt and dry. Apply a layer of plastic cement around the drain opening and over the roof membrane for a distance of 2". (BUR)

STEP 6

Lubricate outside surface of the Super Seal with index finger using silicone compound supplied in small plastic pouch which is attached to this sheet.

STEP 7

Center the drain on existing drain water leader or drain and press all way down to the roofing slowly rotating and pushing into position a minimum of 2-1/2" into drain water leader.

STEP 8

Apply membrane flashing as follows:

BUR: Flash in over the drain deck flange with 3 overlapping layers of felt flashing. Over drain deck flange 4" and 6" onto roof.

ModBit: Torch membrane until bitumen is fluid and set drain flange into fluid. Flash in flange with two overlapping layers of ModBit and seal with asphalt sealer.

Single Ply: Set drain flange in layer of membrane adhesive before applying membrane over flange. Note: for PVC membrane, use PVC coated drain flange; weld roofing to drain flange using PVC torch.

Precautions: If coating drain flange with a bituminous paint on site, allow 24 hours for drying before applying roof membrane.

STEP 9

Reinstall the compression unit if removed into the funnel by turning until snug. Place the Cast Aluminum Strainer centered to drain body.

Carefully bolt down the strainer with 3/8" s.s bolt into the compression unit to clamp the membrane to the deck flange.

Hand tighten the bolt; three full turns with torque wrench # 9/16" are required. Do not overtighten.

STEP 10

Install stainless steel Underdeck Clamp. (Optional)

Installation Instructions

concrete deck retrofit

RDX30 RR

THE NEW BIBLE FOR QUALITY ROOF SPECIALTIES



TESTAMENT TO THE ROOFING INDUSTRY FOR 36 YEARS www.thalermetal.com

4, 5, 6

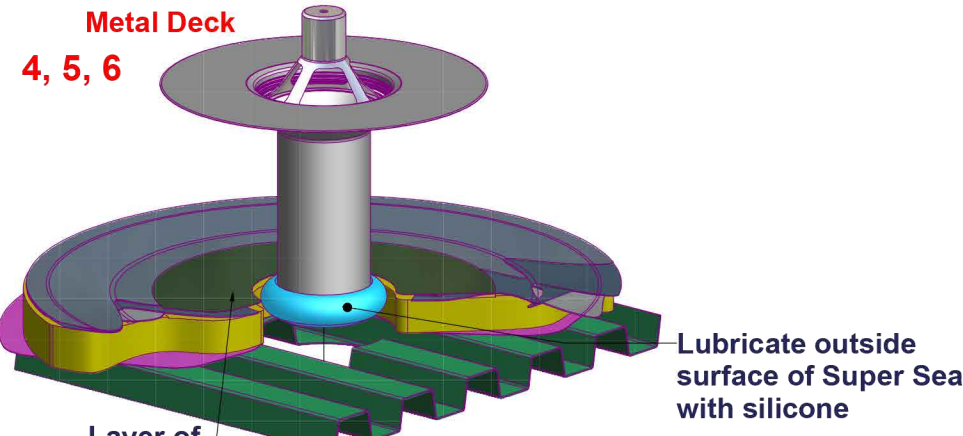

Super Seal is injection molded from EPDM. It is manufactured to fit 2", 3", 4", 5" and 6" Pipes. Fits on PVC, Cast Iron, Steel and Copper Drain Water Leaders.

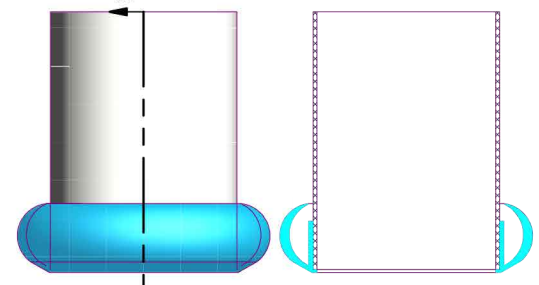

Layer of Plastic Cement

Lubricate outside surface of Super Seal with silicone

7

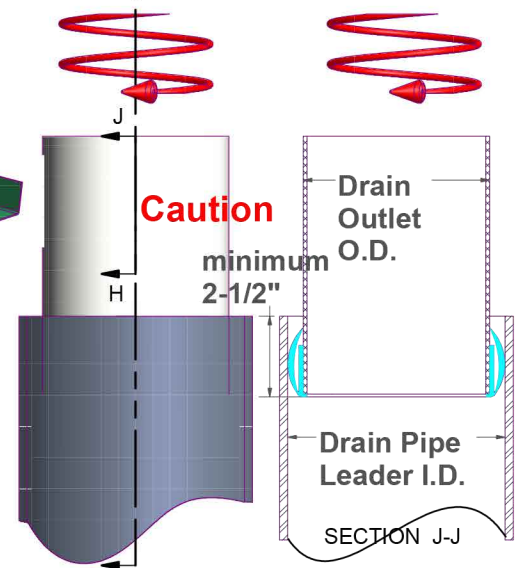
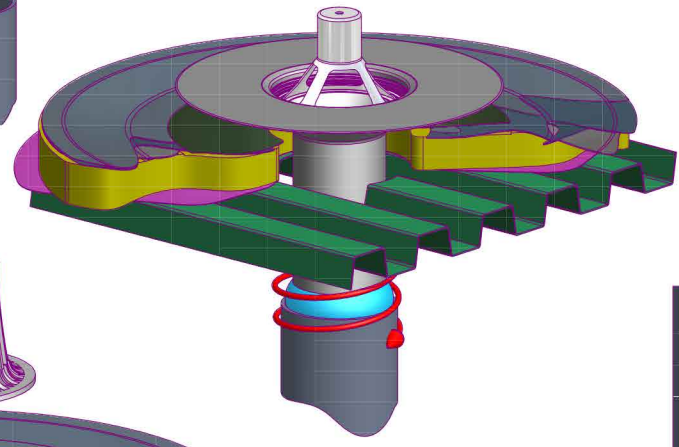

apply membrane flashing neatly around drain opening using inside lip of flange as a guide

Caution

minimum 2-1/2"

Drain Outlet O.D.

Drain Pipe Leader I.D.

SECTION J-J

To use Thaler Super Seal for other types of Drains see chart for Drain Outlet Pipe sizes.

8, 9, 10

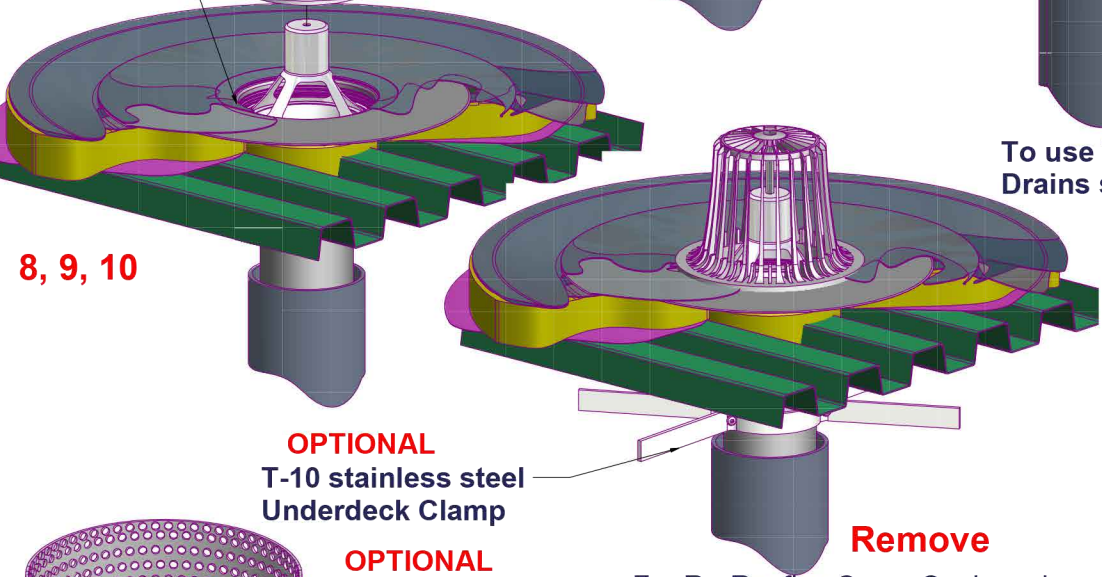

OPTIONAL
T-10 stainless steel Underdeck Clamp

Remove

For Re-Roofing Super Seal can be reused, by gently rotating and pulling upward. Once the drain is removed as well as the rest of the roof, simply follow the above installation steps and Super Seal will continue sealing drain pipe until the next re-roof occurs.

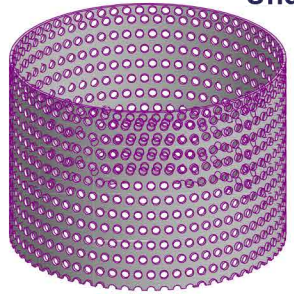

OPTIONAL
Optional T-12 stainless steel Ballast Guard Accessory friction fitted over, Cast Aluminum Strainer.

Nominal Size Steel Drain Pipe Leader	"Drain Pipe Leader" I.D.	"Drain Outlet" Pipe O.D.
2" (51 mm)	1.97" (50 mm) Sched 80	1.37" (34.8 mm)
	2.06" (52.3 mm) Sched 40	
3" (76 mm)	2.92" (74.2 mm) Sched 80	2.35" (59.7 mm)
	3.070" (78 mm) Sched 40	
4" (102 mm)	3.84" (97.5 mm) Sched 80	3.32" (84.3 mm)
	4.04" (102.6 mm) Sched 40	
5" (127 mm)	4.875" (124 mm) Sched 80	4.34" (110 mm)
	5.084" (129 mm) Sched 40	
6" (152 mm)	5.743" (146 mm) Sched 80	5.258" (134 mm)
	6.050 (154 mm) Sched 40	

OPTIONAL

Optional Aluminum T-7 Flow Control Accessory friction fitted to Drain Body, before installing the Cast Aluminum Strainer. See Flow Control Chart in Thaler Catalogue page M-28.

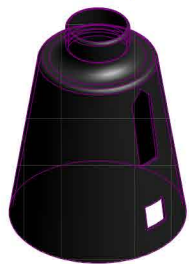

THE NEW BIBLE FOR QUALITY ROOF SPECIALTIES



TESTAMENT TO THE ROOFING INDUSTRY FOR 36 YEARS
www.thalermetal.com